

HOMESITE 25

HENNESSEY

THE TOWNES OF FOREST HILLS

APPROXIMATELY 1,980 SQ. FT.

3 BEDROOM, 2 ½ BATH

GRAND TWO-STORY ENTRANCE

ONE CAR GARAGE/FULL BASEMENT

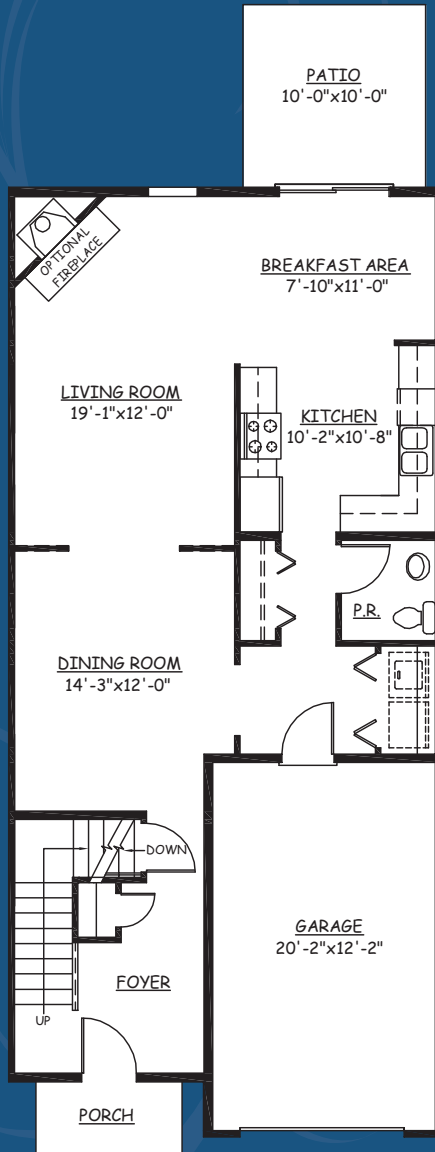

FIRST FLOOR

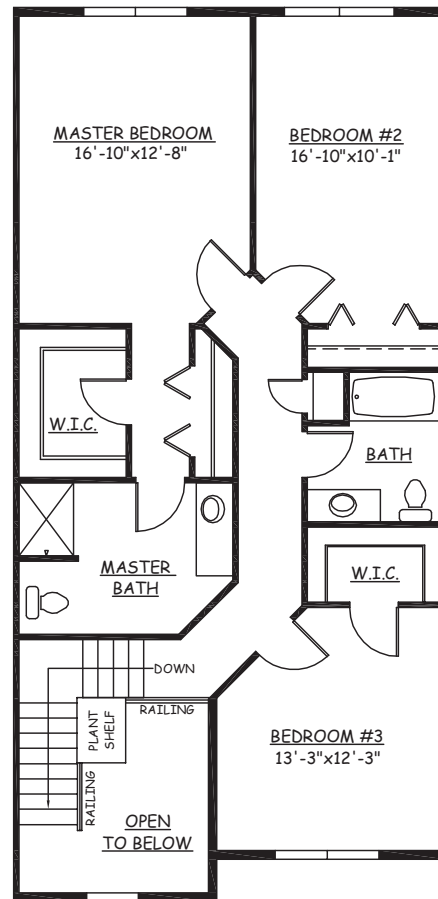

SECOND FLOOR



This sheet is for illustrative purpose only and not part of a legal contract. Plans are subject to modification. Room measurements are approximate. Individual unit elevations are based on an entire building and may vary. Optional items indicated are available at additional cost. Refrigerator, washer and dryer are not included. Illustration is artist's conception and may vary in precise detail. (02-24-11)